



DIAMOND TOWERS

Redefined space to unleash
creativity & maximise productivity

By



WE BUILD TRUST

www.sasinfra.com

SAS Infra - Redefining the Skyline of Hyderabad

SAS Infra is an innovation-based real estate company: a standing testimony of 'Think Global – Act Local' that is set to revolutionise the real estate sector in Hyderabad.

A confluence of handpicked International expert firms across selected genres blended with deep-rooted local networks. We have leveraged our world-class capabilities in technology, design, and ground-breaking trends to create milestone projects such as the iTower, Crown, and Diamond Towers. We don't just build buildings, we build Trust; an attribute that's most valued and expressed in all our dealings across stakeholders.

Crafting innovative projects on par with international standards and standing tall as an emerging giant making a world of difference to the realty sector in Hyderabad.

Notable Achievements at a glance:

SAS Infra has been lauded for its projects and is proud to share these inspiring recognitions.

- SAS iTower has been awarded as the “**Highly Commended Business Park of the Year 2021 (South India)**” at the National Excellence Summit by World Business Review Corporation.
- SAS Infra has been awarded the “**Emerging Developer of the Year 2021**” by CNN News 18 - Real Estate & Business Excellence Awards.
- Forbes India considered SAS Infra the Game changer of the Hyderabad Realty Market. (It was covered by an article in Forbes in March 2020)

SAS Crown - South India's tallest residential Skyscraper with extravagant views that offers top-notch luxury. A unique project that offers a lifestyle that is unmatched in the city, this slender 57 Levels high rise stands 236 meters tall.

SAS iTower - Currently the tallest standing commercial tower in South India at 171.5 mtrs, a revolutionary change in the realty sector.





Mindtree

digite

MAS
CHANGE & COURAGE

SAS

SAS

Bios Mall

Robous

Earth says

AVATAR

DHURUV TITICACAS

RERA No: P02400002881

Relax, rewind & rejuvenate at Eco-Deck @ Diamond Tower

The Eco-deck at Diamond Towers is a state-of-the-art facility that seamlessly connects the mall and the office spaces, providing a unique experience for employees and visitors alike. It is a unique facility that promotes health, wellness, and relaxation.

Surrounded by lush greenery and stunning views of the city skyline, the eco deck is a tranquil oasis, that allows employees to recharge and rejuvenate their minds and bodies.

One of the key features of the Eco-deck is the indoor activities that are available. The fully-equipped gym offers modern fitness equipment, making it easy for employees to stay in shape and maintain a healthy lifestyle.

The spa is a sanctuary for relaxation, providing a range of rejuvenating treatments that promote wellness and serenity.

Whether employees are looking for a quick coffee or a delicious meal, the cafes are sure to satisfy their cravings. In addition, the premium lounges provide a space for employees to unwind, socialize, and relax in a comfortable setting.



Leisure @ Diamond Tower

A larger-than-life experience for professionals from all walks of life. The ambience offers a perfect blend of leisure activities after a hectic day, that can add to your stress-free life.

You have abundant opportunities to abide by a brand savvy lifestyle. Be it inside the mall, or enjoy a big screen magic, or even cherish the bite on scrumptious recipes at the chain of best food joints. You have it all.



Business @ Diamond Tower

The commercial space at the Diamond Tower is perfectly inspired to keep you on task. Get down to business amidst crafted facilities in a superior environment to make your workday effortlessly productive



GRADE A
OFFICE SPACES



BUILT AS PER
INTERNATIONAL STANDARDS

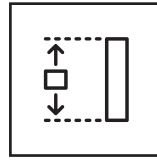

4M HEIGHT FOR
OFFICE FLOOR



1 LAKH SQ. FT FLOOR PLATE
WITH JUST 34 COLUMNS



100%
POWER BACKUP

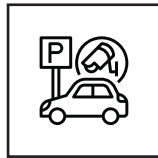

SUBSTANTIAL
CAR PARKING CAPACITY

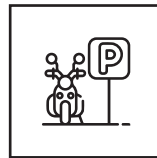

EXTENSIVE PARKING
FOR 2 WHEELERS

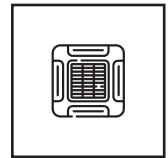

CENTRAL
AIR CONDITIONING

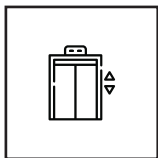

HIGH SPEED ELEVATORS
28 PASSENGER &
9 SERVICE ELEVATORS

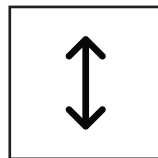

120 METRES
HEIGHT



MODERN FIRE
DETECTION



HIGH STREET
SHOPPING



3.91 Acres | G+27 Floors

Typical floor plan

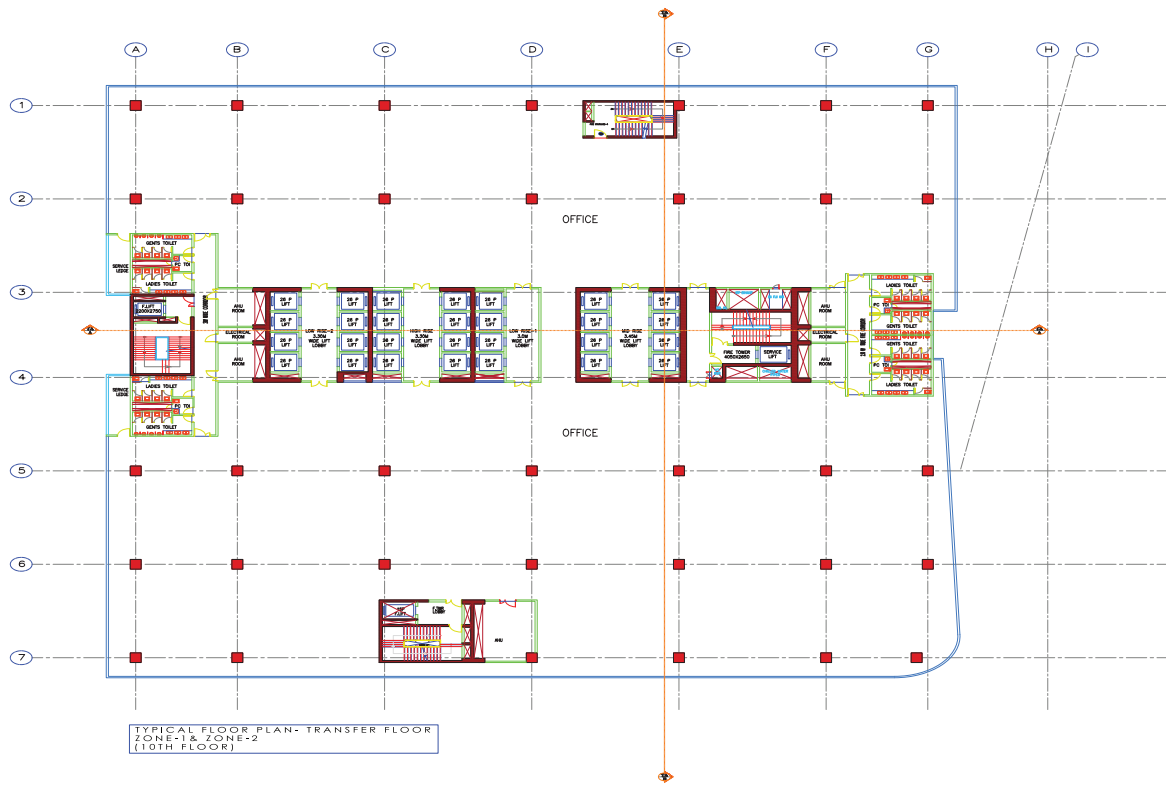

Partnered with the Best



R. Chakrapani and Sons
Principal Consultant
India



Ttec
Traffic Consultant
Mumbai
www.ttec.co.in



RWDI
Wind Analysis Consultant
Global
www.rwdi.com

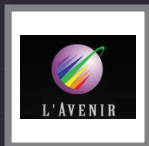

L'Avenir
Vertical Transport
Bengaluru
www.lavenircpl.com



Sahvia
Facade Consultant
Global
www.sahvia.com



Vastech consultants
Structural Consultants
Pune
www.vastechconsultants.com

This brochure is only a conceptual representation of the project and not a legal offering. The promoter reserves the right to alter and make changes in plans, specifications, elevations and any other detail as deemed fit.

SCAN
QR CODE



Location Advantage



DIAMOND TOWERS



SAS INFRRA, #504, 5th Floor, Modern Profound Tech Park, Opposite Ramalayam Temple, Kondapur, Hyderabad - 500 084.

For more information call +91 9718 66 22 99 & Press 2 | Support@sasinfra.com | www.sasinfra.com